

**Notes**

THIS DRAWING IS THE COPYRIGHT OF VIVID DESIGN STUDIO LTD AND MUST NOT BE COPIED, ALTERED OR REPRODUCED IN ANY WAY NEITHER PASSED TO A THIRD PARTY WITHOUT THEIR WRITTEN PERMISSION.

DIMENSIONS TO BE CHECKED ON SITE BEFORE COMMENCING WORK AND ANY DISCREPANCIES SHALL BE REPORTED TO THE DESIGNER. FIGURED DIMENSIONS MUST BE TAKEN IN PREFERENCE TO SCALED DIMENSIONS.

Rev:-	Description:-	Date:-	Chkd by:-
A	Amended layout to match as built on site	06/05/14	

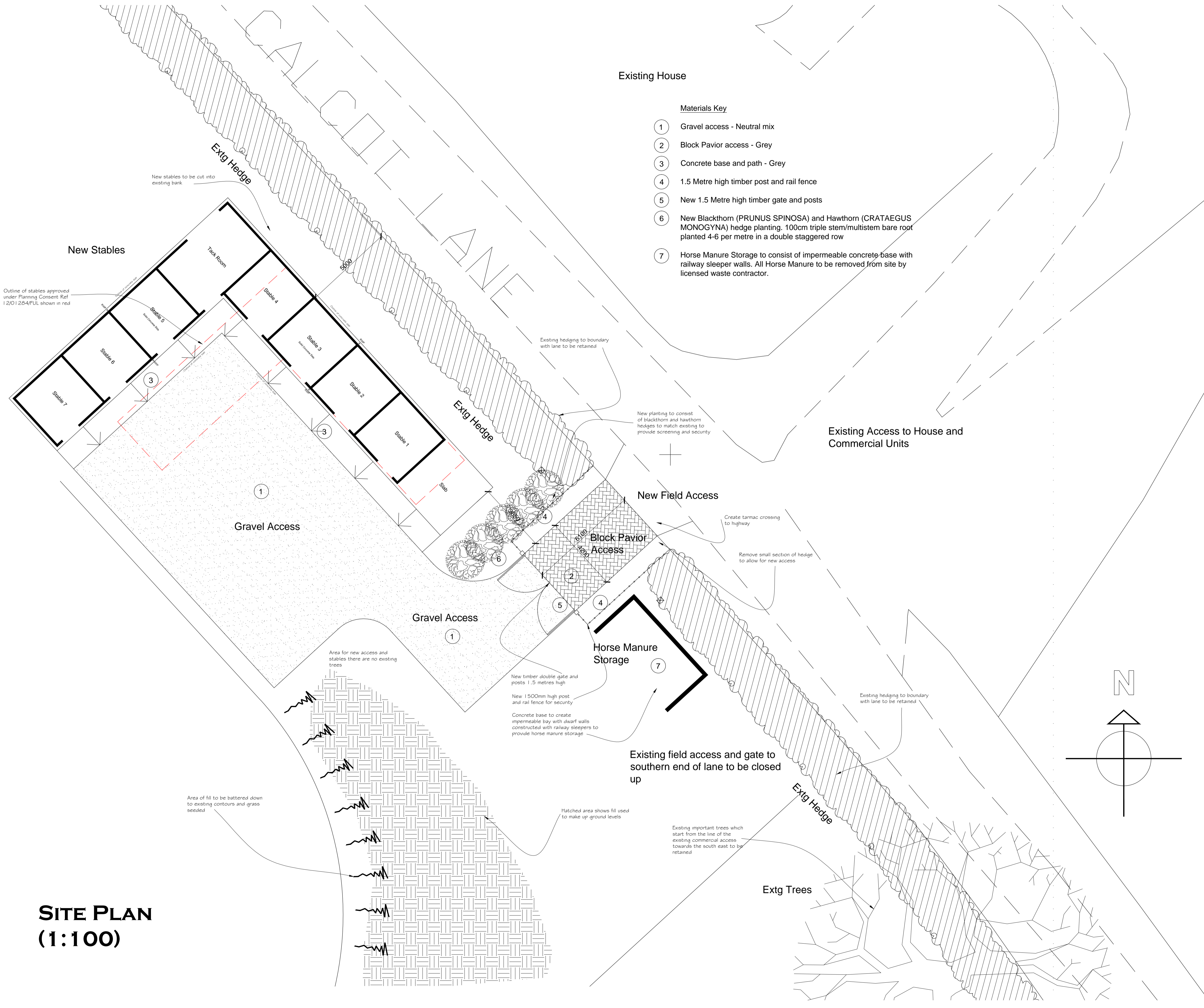

**VIVID**  
design studio



Newborne House, 51-52 West Street, Chichester, West Sussex, PO19 1RP  
Tel: 01243 537552 Fax: 01243 200010  
Email: info@vividdesignstudio.co.uk Website: www.vividdesignstudio.co.uk

Project:-

**Proposed New Stables Land adjoining Calcot Lane Curdridge Hampshire**

Title:-

**Proposed Site Plan**

Client:-

**Mr & Mrs Southcott**

Scale:-

**1:100 (@A1)**

Drawn By:- PJD Checked By:- PJD

Date:- 24/02/14 Date:- 24/02/14

Job.No:- 110098 Drg.No:- 51 Rev:- A