



**Winchester**  
City Council

**Legal  
Services**

City Offices  
Colebrook Street  
Winchester  
Hampshire  
SO23 9LJ

tel 01962 840 222

fax 01962 848 555

telephone calls may be recorded

email [licensing@winchester.gov.uk](mailto:licensing@winchester.gov.uk)

website [www.winchester.gov.uk](http://www.winchester.gov.uk)

DX 120400 WINCHESTER 5

Mr D A Bower  
West Down Farm  
Peststead Lane  
Soberton  
Hampshire

Your Ref:  
Our Ref: FS/PL1/17/9  
Enq to: Fiona Sutherland  
Direct Line: 01962 848 513  
Email: [fsutherland@winchester.gov.uk](mailto:fsutherland@winchester.gov.uk)

IMPORTANT - THIS COMMUNICATION AFFECTS YOUR LAND

22 October 2007

Dear Sir

**Land known as Church Meadow, West Street, Soberton, Hampshire - Direction under Article 4 of the Town and Country Planning (General Permitted Development) Order 1995**

I write to inform you that under Emergency Powers, the Council's Chief Executive authorised the Head of Legal Services to make an Article 4 Direction in respect of the above land.

The Direction was made on 22 October 2007 and will remain in force for six months unless it is approved or disallowed by the Secretary of State. A copy is enclosed for your information.

The effect of the Direction is that should any person wish to carry out development specified in the First Schedule they will first need to make an application to the City Council for planning permission.

Yours faithfully

H. Bone  
Head of Legal Services

**ARTICLE FOUR DIRECTION**

**WINCHESTER CITY COUNCIL**

**TOWN AND COUNTRY PLANNING ACT 1990  
GENERAL PERMITTED DEVELOPMENT ORDER 1995**

Direction under Article 4 of the General Permitted Development Order 1995  
restricting Permitted Development

**RECITALS**

1. Winchester City Council ("the Authority") is the local planning authority in respect of the area of land specified in this Direction.
2. The Authority is satisfied that it is expedient that the development described in Schedule 2 to the General Permitted Development Order 1995 ("the Order") and specified in this Direction should not be carried out unless permission is granted for it on application.

**NOW THEREFORE** the Authority in pursuance of article 4 of the Order and all other powers thereby enabling

**DIRECTS THAT**

1. The permission granted by article 3 of the Order shall not apply to development specified in the First Schedule to this Direction in the area specified in the Second Schedule to this Direction ("the Land").
2. It is expressly provided that this Direction shall apply to the erection, construction, maintenance, improvement or alteration of a gate, fence, wall or other means of enclosure.
3. Pursuant to article 5(4) of this Order, this Direction does not require the approval of the Secretary of State because it relates only to development permitted by Parts 1 to 4 of Schedule 2 to this Order and the Authority considers that development would be prejudicial to the proper planning of its area or constitute a threat to the amenities of its area. The Direction shall expire at the end of six months from the date on which it is made unless disallowed or approved by the Secretary of State. The Direction shall, in accordance with article 5(10) of the Order, come into force in respect of any part of the Land on the date on which notice of the making of the Direction is served on the occupier of that part of the Land or, if there is no occupier, the owner. If the Authority considers that individual service on the owners or

occupiers of the Land is impracticable because the number of them makes such service impracticable or because it is difficult to identify or locate one or more of them, the Authority shall publish a notice of making the Direction in a newspaper circulating in the locality in which the Land is situated and, in accordance with article 5(15) of the Order, the Direction shall come into effect on the date on which the notice is first published.

FIRST SCHEDULE

1. The erection, construction, maintenance, improvement or alteration of a gate, fence, wall or other means of enclosure being development comprised within Class A of Part 2 of Schedule 2 to the Order, and not being development comprised within any other Class,

SECOND SCHEDULE

Land known as Church Meadow, West Street, Soberton, Hampshire shown edged in red on the attached plan.

The COMMON SEAL of WINCHESTER )  
CITY COUNCIL of City Offices, Colebrook )  
Street, Winchester, Hampshire was )  
affixed this 22nd day of October 2007 )  
in the presence of : )

*[Handwritten signature]*

Head of Legal Services

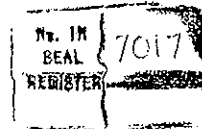

# Church Meadows

Land off West Street, Soberton



**Winchester**  
City Council

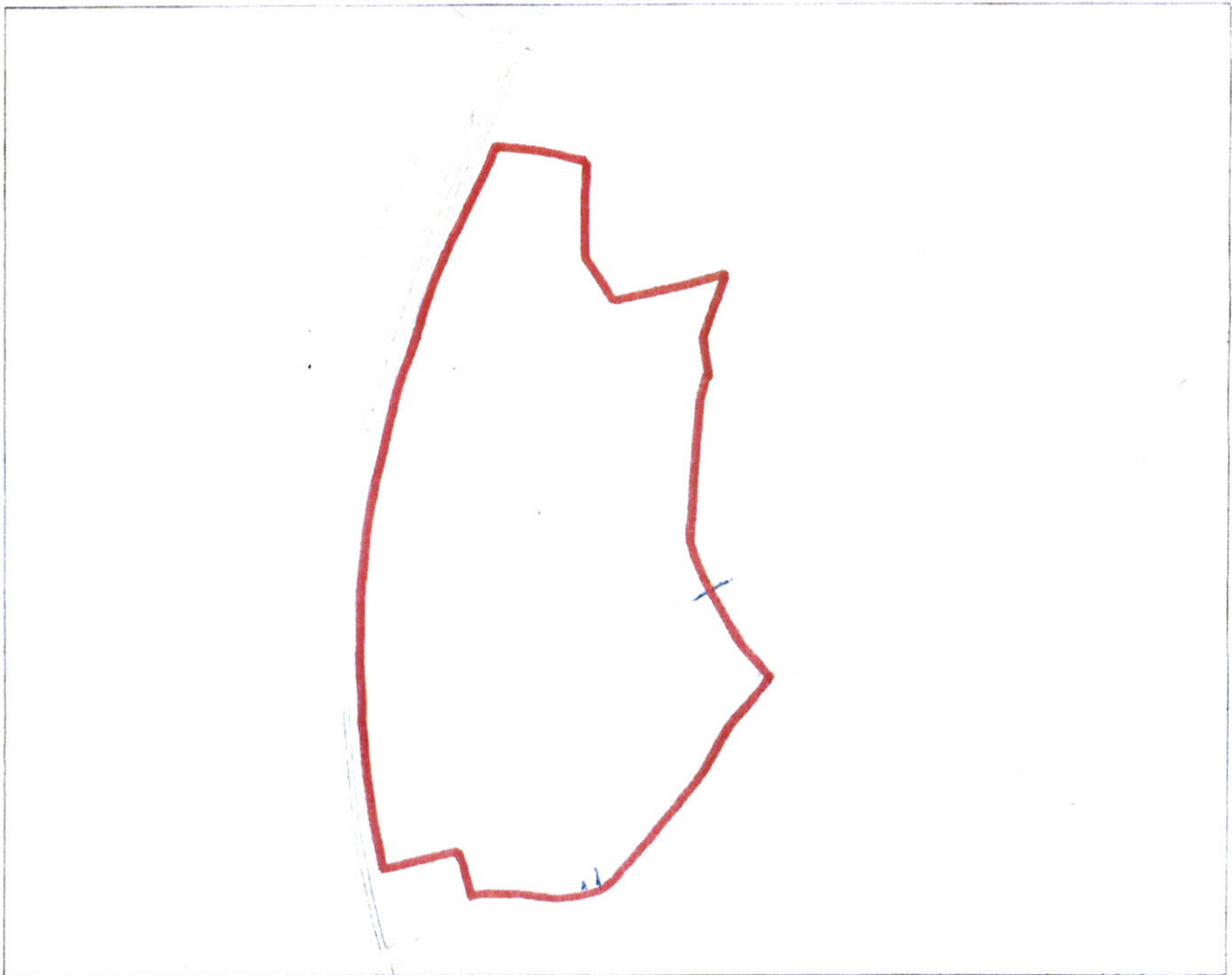

### Legend

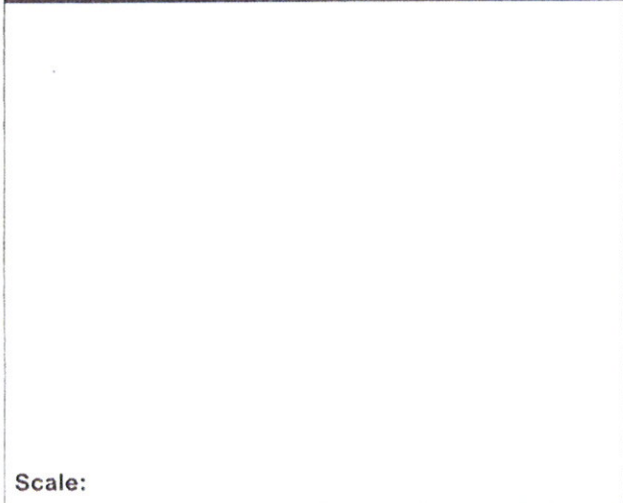

Scale:

Metres 50 100 150 200 250 300 350 400

Reproduced from the Ordnance Survey map with the permission of the Controller of Her Majesty's Stationery Office © Crown Copyright  
Unauthorised reproduction infringes Crown Copyright and may lead to prosecution or civil proceedings. Winchester City Council © 2007.

<b>Organisation</b>	Winchester City Council
<b>Department</b>	Development Services
<b>Comments</b>	Article 4 Direction
<b>Date</b>	19 June 2007
<b>SLA Number</b>	00018301