

**These are the notes referred to on the following official copy**

Title Number SH21485

The electronic official copy of the document follows this message.

This copy may not be the same size as the original.

Please note that this is the only official copy we will issue. We will not issue a paper official copy.

£2000

W. J.



26 NOV 1912

FINANCE ACT 1911

2



# This Conveyance

is made the first day of November One thousand nine hundred and eighty two BETWEEN

LEONARD THOMAS HALL of Glebe Farm Buriton Hampshire (hereinafter called "the Vendor") of the one part and BUTSER TURF AND TIMBER COMPANY LIMITED whose registered office is at Horndean Hampshire (hereinafter called "the Purchaser") of the other part  
W H E R E A S the Vendor is seised of the property hereinafter described for an estate in fee simple in possession subject as hereinafter mentioned but otherwise free from incumbrances and has agreed to sell the same to the Purchaser for the like estate at the price of One hundred thousand pounds

NOW THIS DEED WITNESSETH as follows :-

1. In pursuance of the said agreement and in consideration of the sum of ONE HUNDRED THOUSAND POUNDS paid by the Purchaser to the Vendor (the receipt whereof the Vendor hereby acknowledges) the Vendor as Beneficial Owner hereby conveys unto the Purchaser ALL THOSE pieces or parcels of land situate at Buriton Hampshire containing 75.17 acres or thereabouts as the same are shown for the purposes of identification only coloured blue on the plan annexed hereto comprising Lot 7 and more particularly described in the First Schedule hereto TO HOLD the same unto the Purchaser in fee simple subject to the exceptions and reservations contained in a Conveyance dated the Twenty first day of April One thousand nine hundred and fifty eight by The Minister of Agriculture Fisheries and Food to the Vendor details whereof are set out in the Second Schedule hereto in so far as the same relate to the property hereby conveyed and are now subsisting and capable of being enforced.

IN WITNESS whereof the Vendor has hereunto set his hand and seal the day and year first above written

### THE FIRST SCHEDULE

<u>OS NUMBER</u>	<u>DESCRIPTION</u>	<u>ACREAGE</u>
3925	Permanent Pasture	0.46
3930	Permanent Pasture	4.90
3745	Permanent Pasture	3.15
2041	Permanent Pasture	5.83
1655	Permanent Pasture	13.85
2672	Permanent Pasture	6.81
2078	Track	0.37
0267	Track	0.97
9849	Permanent Pasture	7.95
9000 pt.	Woodland	0.50 Estimate
1100	Permanent Pasture	28.12
8477	Woodland	2.26
	Total Acreage	<u>75.17</u>

### THE SECOND SCHEDULE

The exceptions and reservations contained in the said Conveyance dated the Twenty first day of April One thousand nine hundred and fifty eight

EXCEPTING AND RESERVED unto the Minister (which expression includes the Forestry Commissioners) and his successors in title in fee simple for the benefit of the whole

817249

and every part of the Minister's adjoining property known as Buriton Estate and his and their agents tenants servants and workmen and all persons authorised by him or them at all times hereafter the following rights namely

(a) Full right and liberty for all persons with or without horses carts or other vehicles mechanically propelled or otherwise to pass and repass over and along the road or way delineated on the said plan and thereon coloured green between the points C to D D to E and E to F thereon The Minister making good any damage caused by his user of the said road or way ~~reserving him~~ the right to make up the said road or way into a metalled road of not more than twelve feet in width subject to the Purchaser making good or indemnifying the Minister for any damage to the same caused by his user thereof \_\_\_\_\_

(b) The full right and liberty to stack timber in and upon part of Ordnance Survey No. 3925 provided that this right shall only be exercised by the Minister or Forestry Commissioners and his or their agents and workmen \_\_\_\_\_

SIGNED SEALED AND DELIVERED by the said

LEONARD THOMAS HALL in the presence of :-

*L. T. Hall.*

*Mr. Bagei  
Petersfield, Hants  
Legal Executive.*

6400  
1-78  
6400  
16-11



Buriton Estate and his  
authorised by him or  
others carts or other  
vehicles over and along the  
green between the points  
any damage caused by  
make up the said road  
with subject to the  
made to the same caused

part of Ordnance Survey  
the Minister or Forestry

**Weller Eggar**



FARM AGENCY DEPARTMENT  
74 CASTLE STREET,  
FARNHAM, SURREY.  
Tel (0252) 716221

GLEBE FARM  
BURITON  
NR PETERSFIELD  
HAMPSHIRE

FOR SALE BY PRIVATE TREATY

NOTE - This plan is reproduced from the  
Ordnance Survey Map with the sanction  
of the Controller of the H.M. Stationery  
Office. Crown Copyright reserved.

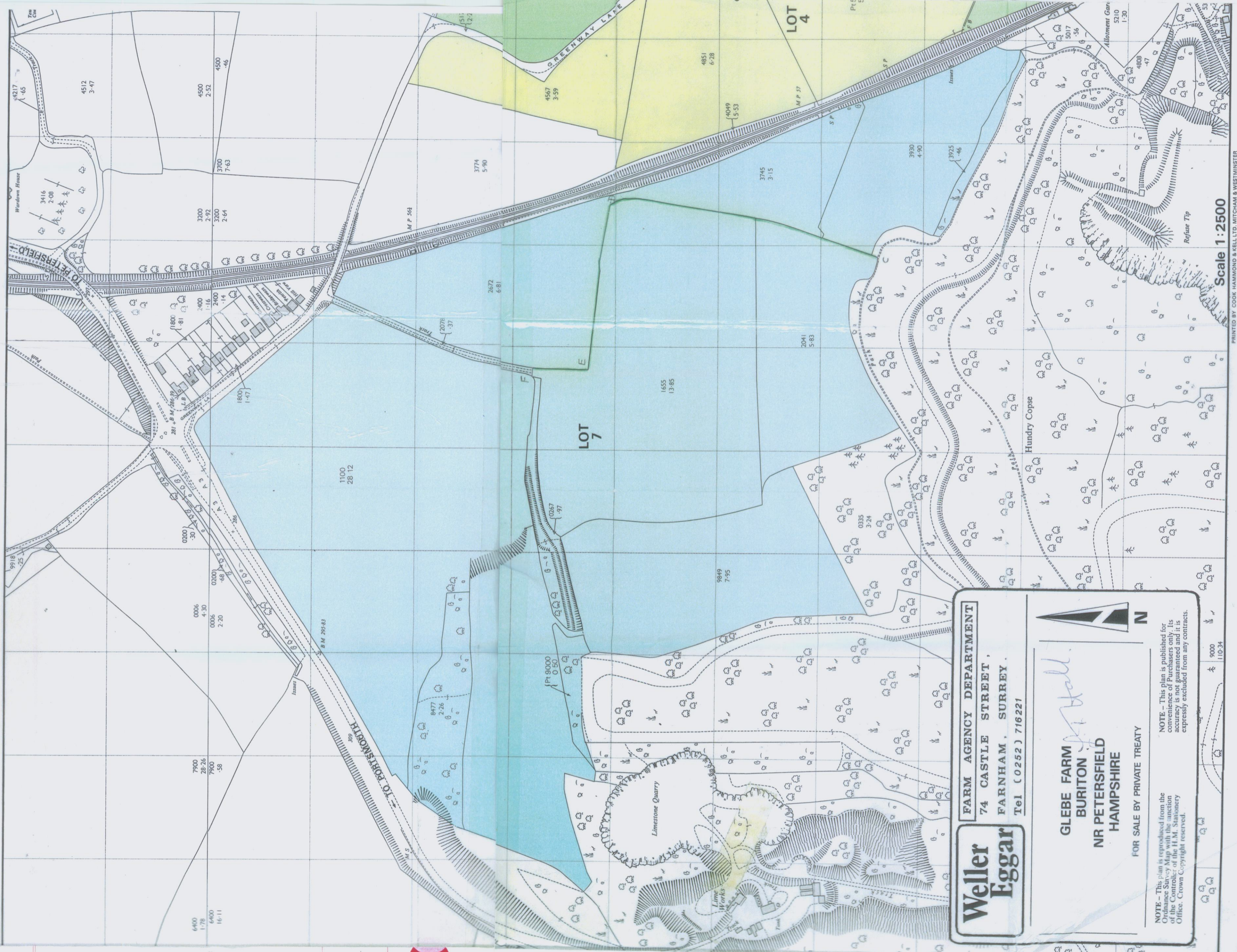
NOTE - This plan is published for  
convenience of Purchasers only. Its  
accuracy is not guaranteed and it is  
expressly excluded from any contracts.



Scale 1:2500

PRINTED BY COOK HAMMOND & KELL LTD, MITCHAM & WESTMINSTER